

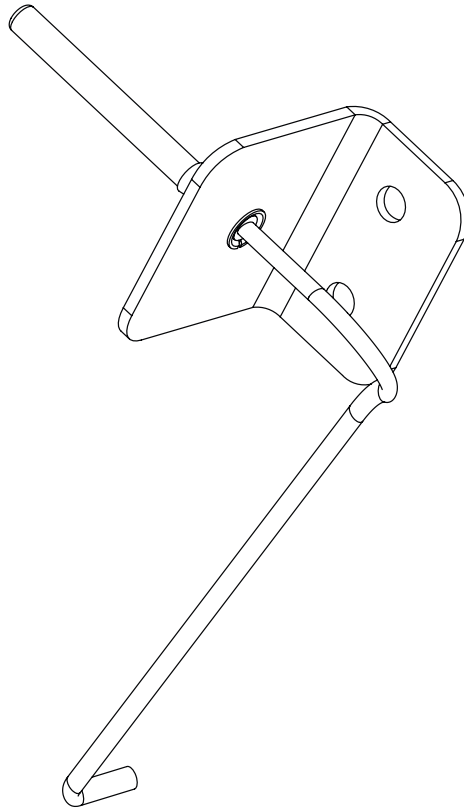

# SHORT THERMOCOUPLE REPLACEMENT

YS1500S INSTALLATION INSTRUCTIONS



## TOOLS YOU'LL NEED

5/16" Socket | Small Adjustable Wrench | Phillips Screwdriver | Small Flathead Screwdriver

## THINGS TO REMEMBER



**UNPLUG**  
POWER CORD



**REMOVE**  
COOKING GRATES



**REMOVE**  
HEAT DIFFUSER



**EMPTY**  
THE HOPPER



**CAUTION:** BEFORE BEGINNING THIS PROCEDURE, ENSURE THAT THE POWER CORD TO THE SMOKER IS DISCONNECTED! FAILING TO DO SO MAY RESULT IN BODILY INJURY.  
**COMPETITION CART MODELS REQUIRE UNPLUGGING THE POWER CORD FROM THE HOPPER LOCATED UNDER THE CART.**

## STEP 1

Remove the end panel by removing the eleven self-drilling screws using the 5/16" socket to gain access into the hopper.

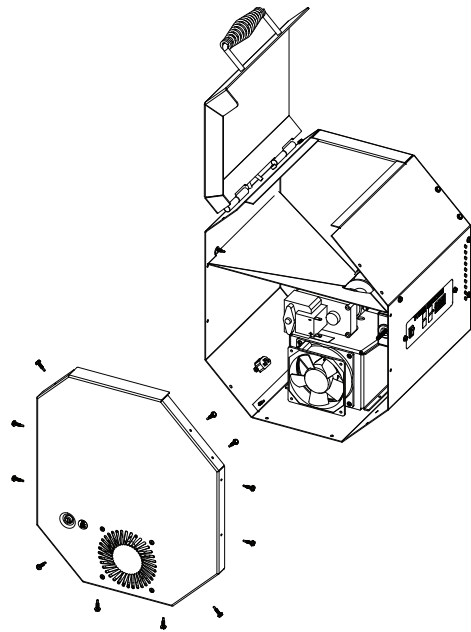

## STEP 2

Disconnect the two wires (one green, one white) from the outer fan.

**NOTE: On competition cart models disconnect the two purple wires from the fuse holder.**

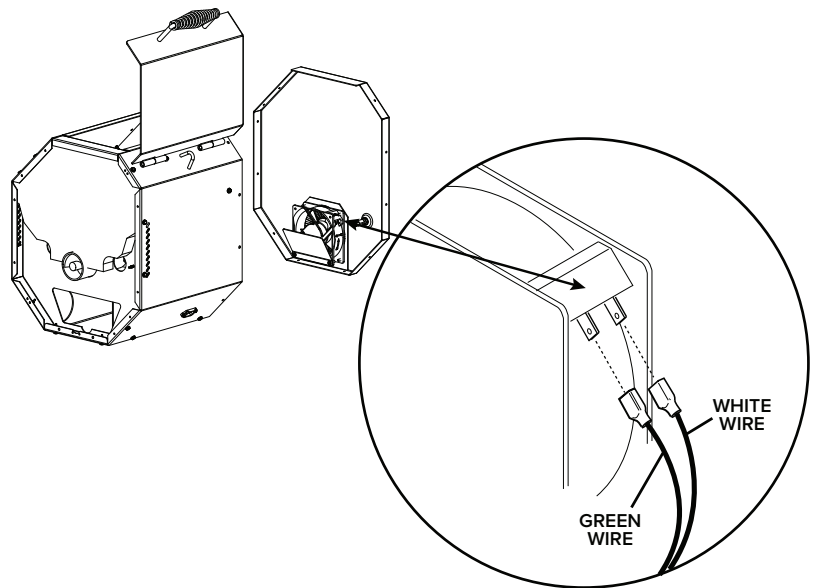

## STEP 3

Disconnect the purple wires from the fuse holder.

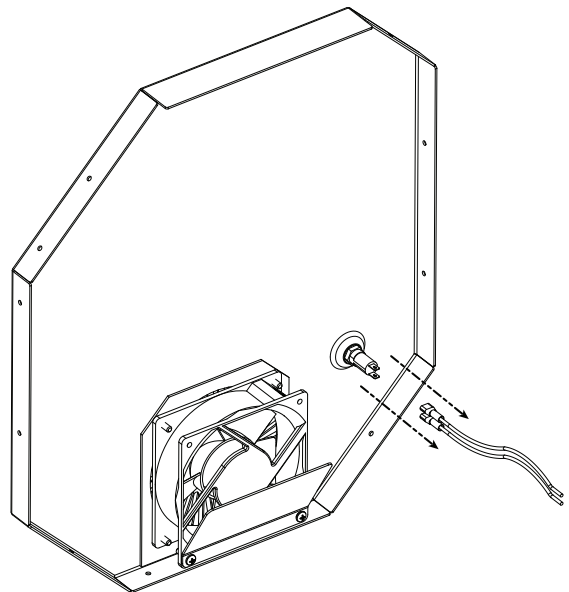

## STEP 4

*Disconnect the Wi-Fi extension wire from the controller using a small adjustable wrench.*

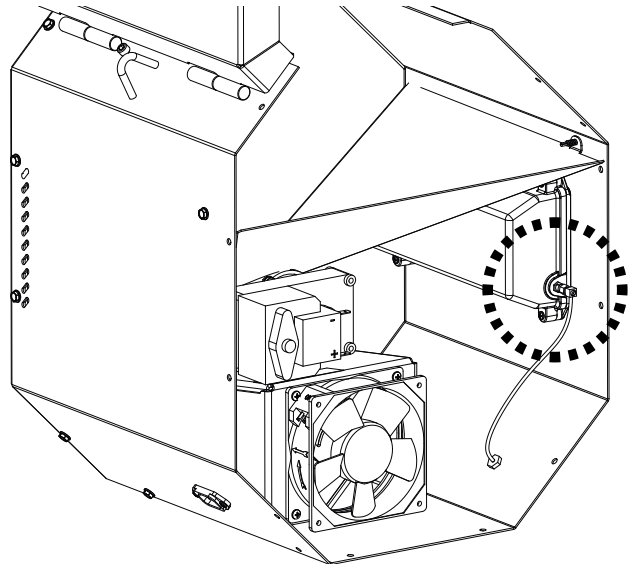

## STEP 5

*Remove the two screws from the controller using a Phillips head screwdriver..*

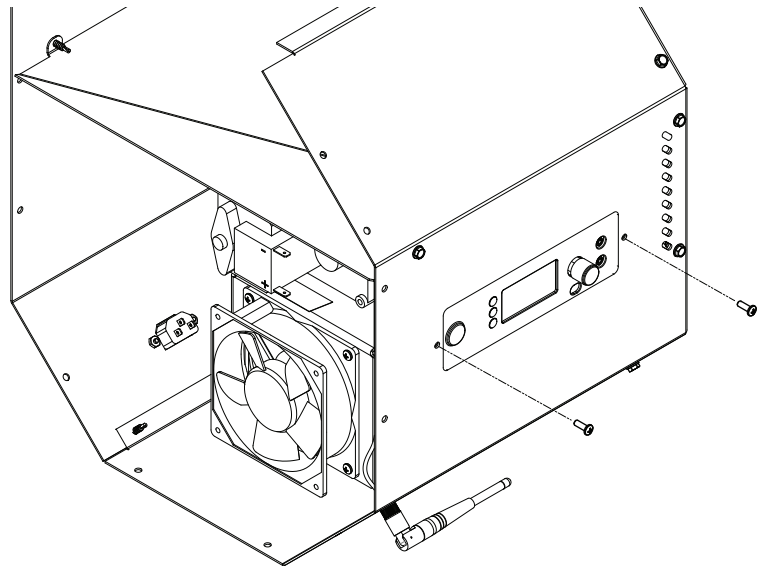

## STEP 6

*Remove the four screws located on the back side of the controller box..*

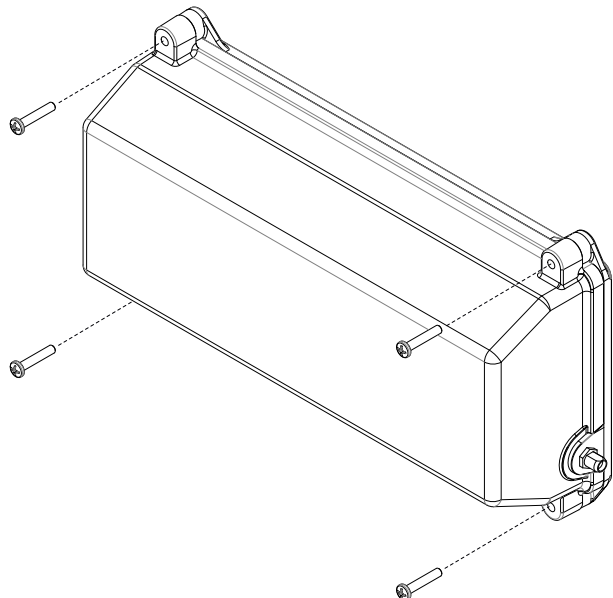

## STEP 7

Carefully remove the box from the controller by sliding the harness through the slot in the box.

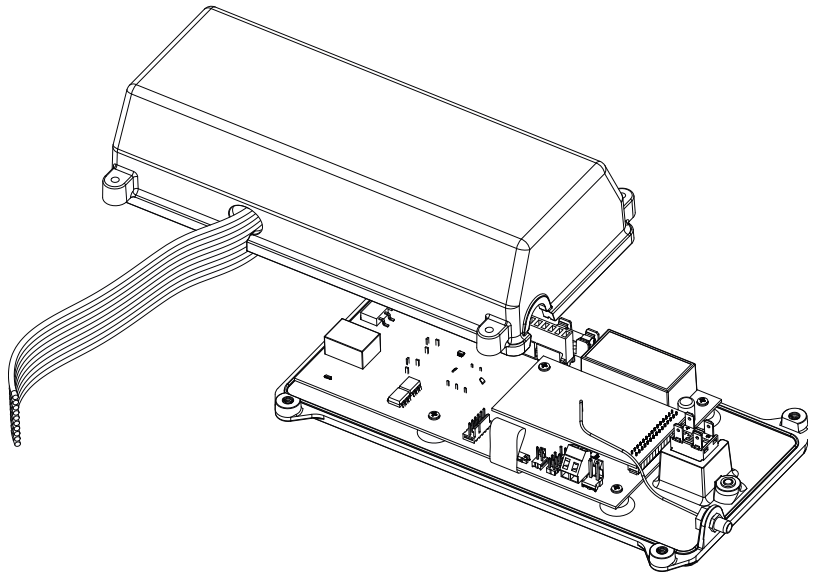

## STEP 8

Using the small flat head screwdriver, disconnect the red and white thermocouple wires from the terminals on the ACS controller.

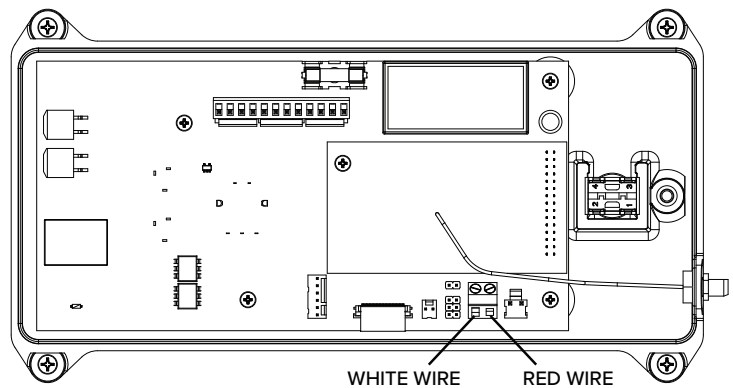

## STEP 9

To replace the thermocouple, begin by removing the thermocouple and bracket from the chamber using a phillips head screwdriver and 5/16" socket. Discard the thermocouple assembly, but save the screws and nuts for use in the next step.

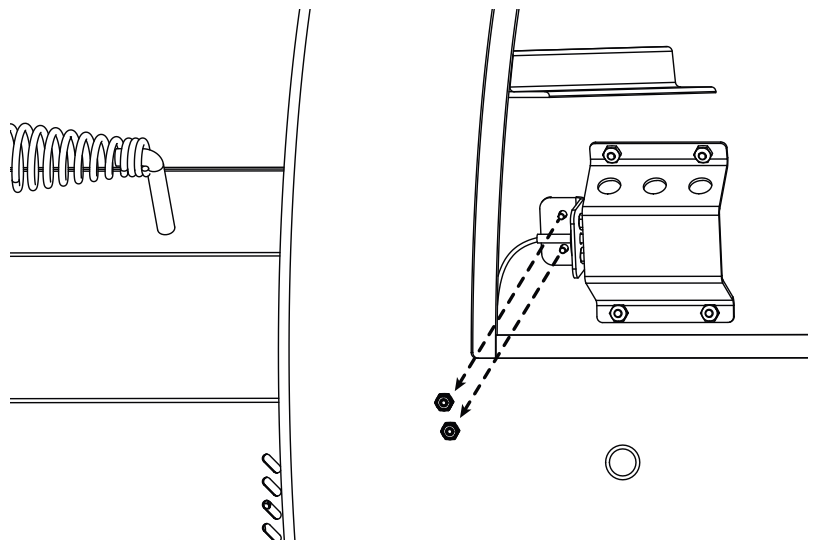

## STEP 10

Feed the thermocouple wire through the hold on the chamber wall and into the hopper. Using the screws and nuts from the previous step, install the short thermocouple into the same the holes in the chamber from the previous thermocouple.

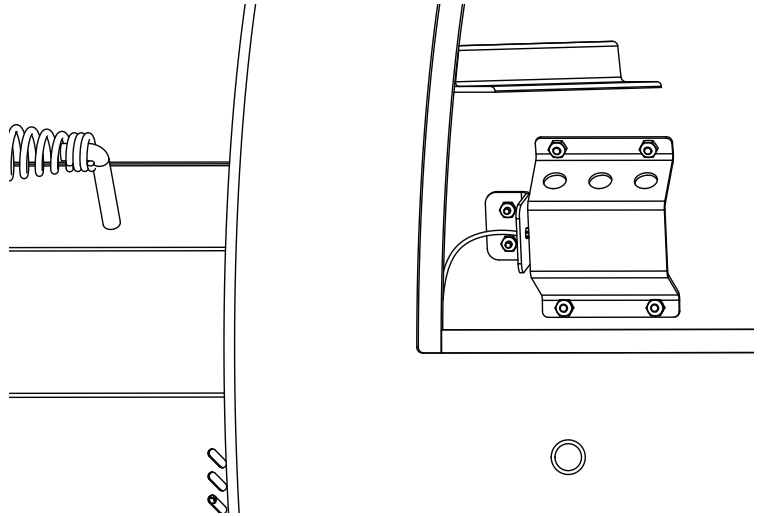

## STEP 11

Using the small flat head screwdriver, install the red and white thermocouple wires into the correct terminals on the ACS controller. When installing the new thermocouple wires, please double check your connection to make sure there is little to no exposed wire where they are connected to the terminal..

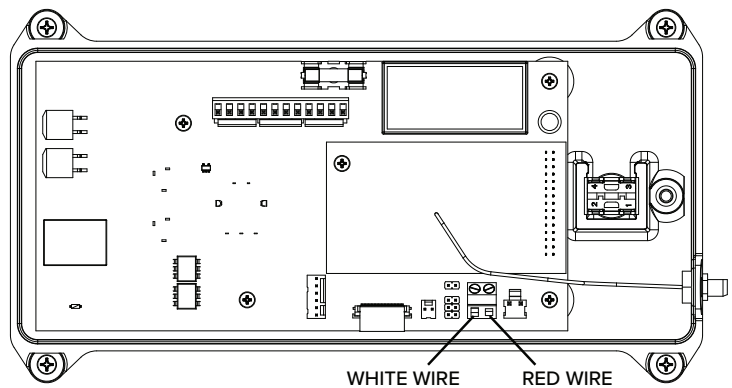

## STEP 12

Slide the harness and thermocouple wire through the slot on the box and secure the box to the controller using the four screws removed earlier.

**NOTE:** Take care to not crimp or pinch the ribbon cable or any wires in the process of closing the box.

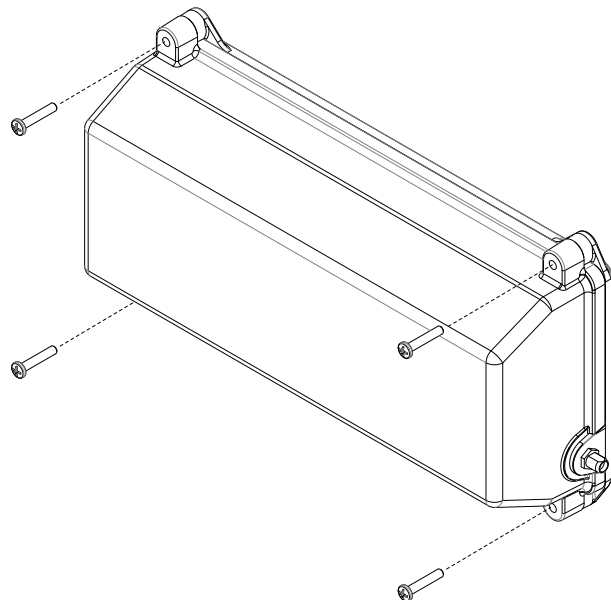

## STEP 13

*Install the ACS controller into the hopper and secure it in place using the two screws removed from the faceplate.*

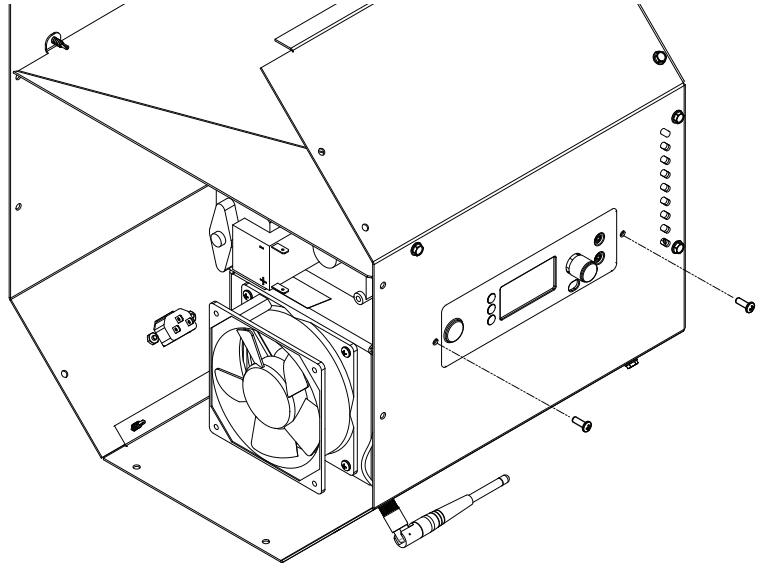

## STEP 14

*Attach the Wi-Fi extension wire to the controller using a small adjustable wrench.*

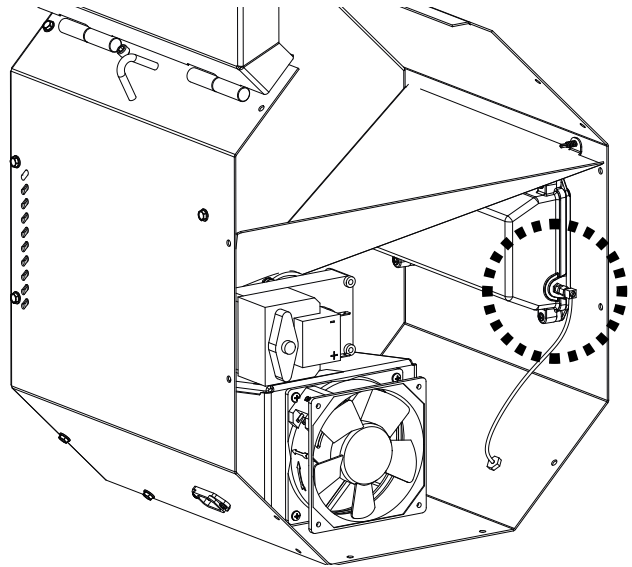

## STEP 15

*Connect the two purple wires to the fuse holder.*

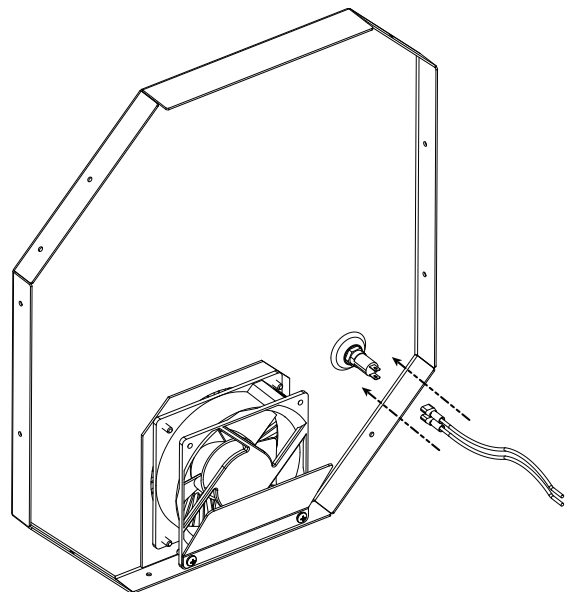

## STEP 16

Connect the two wires (one green, one white) to the outer fan.

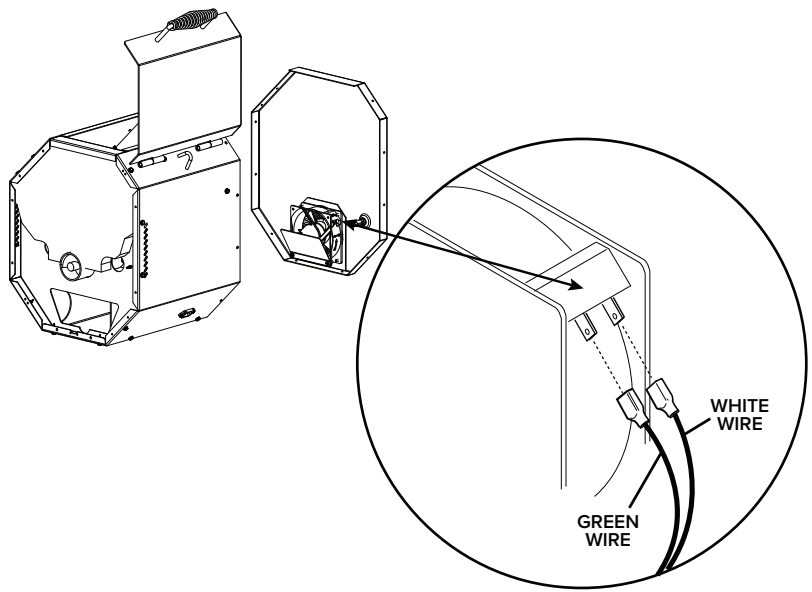

## STEP 17

Ensure all wires are free of both fans and the auger drive motor. Lastly, attach the end panel to the hopper using the eleven self-drilling screws.

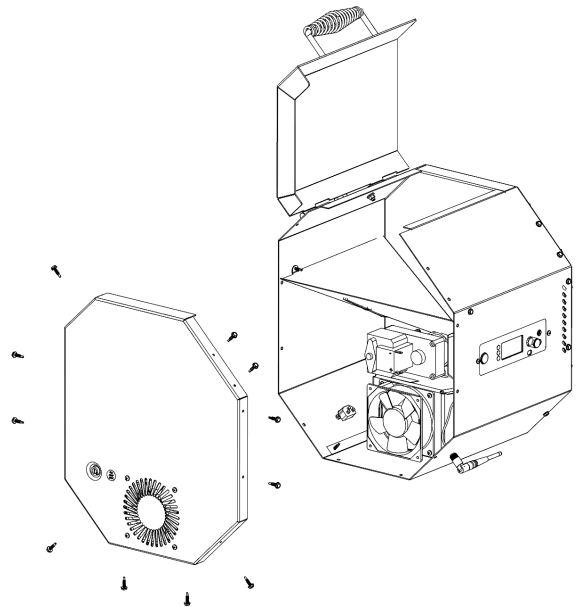

# THIS COMPLETES THE HARDWARE INSTALL



**FOR PRODUCT SUPPORT:**  
**877.409.6337 (Ext. 2)**  
**customerservice@yodersmokers.com**

**WWW.YODERSMOKERS.COM**