

YODER ★ SMOKERS

PROCEDURE FOR COVERING PELLET SMOKERS (YS640 & YS480) WITH HEAT BLANKETS

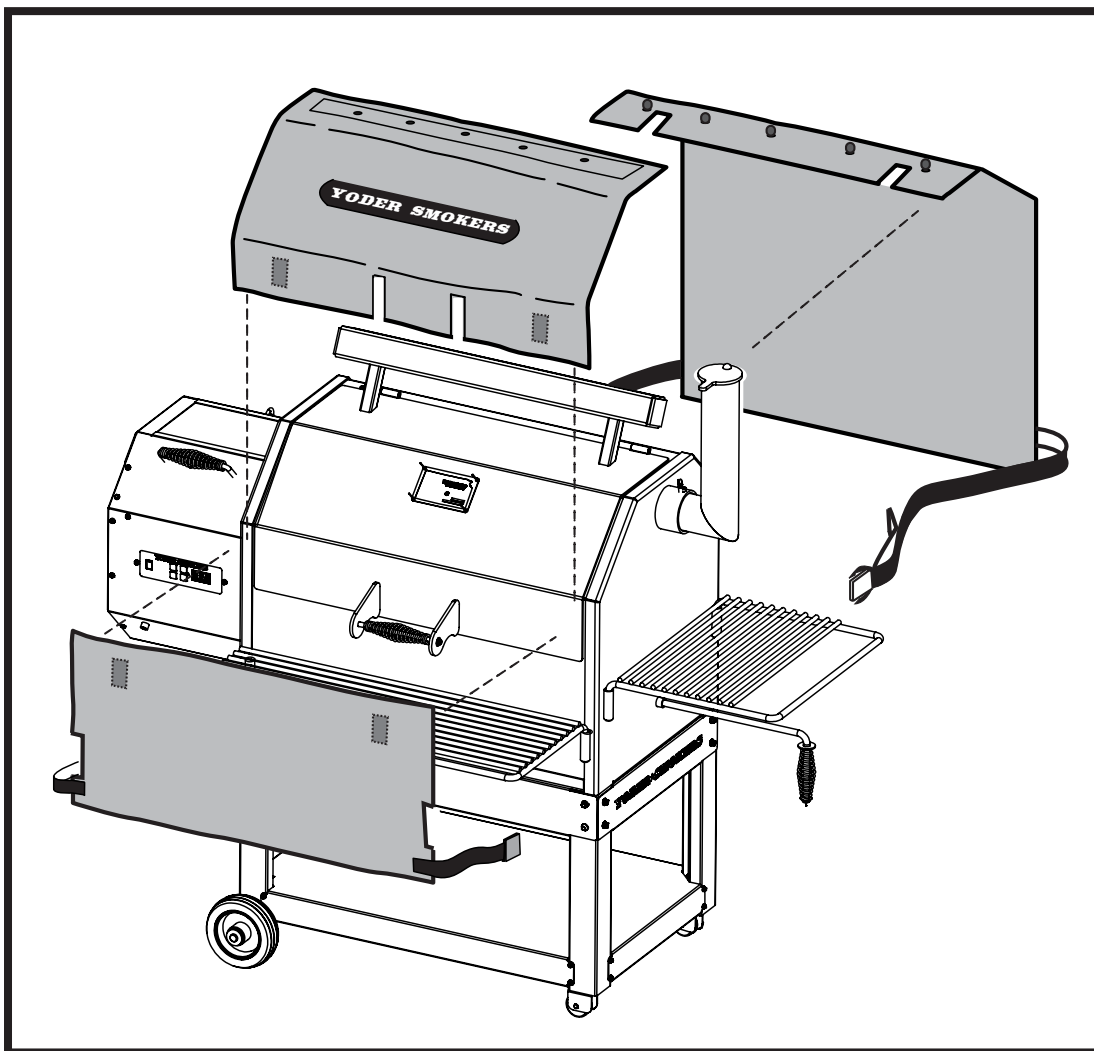

VERS I - 1/3/012

Attach your custom Yoder Smoker Heat Blankets as follows:

ESSENTIAL SAFETY MEASURE:

Avoid burned skin: assure that the smoker is cool to the touch before beginning this assembly.

INSTALL BLANKETS:

The Heat Blanket assembly consists of three pieces: a) Front, b)Top, and c)Back.

1. Installation of Front Blanket:

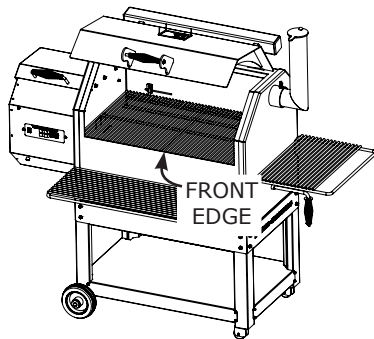

First, raise the lid to the cooking chamber, exposing the front edge of the chamber.

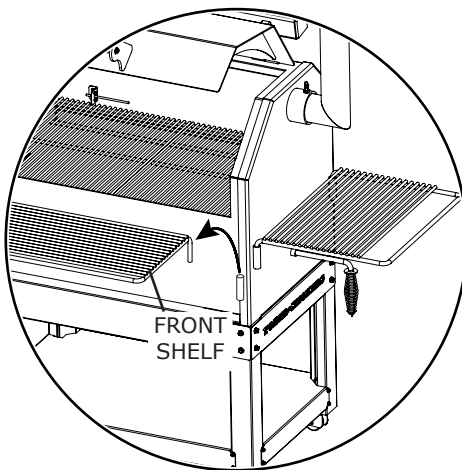

Next, remove the front shelf (can be left off until blanket installation is completed)

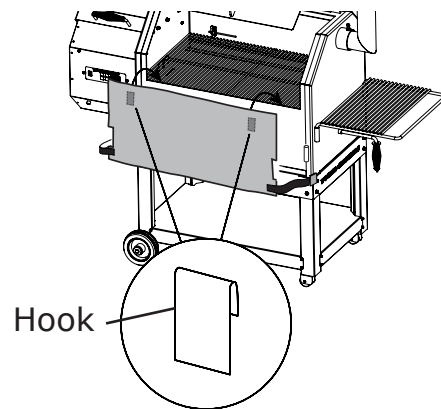

Locate the two hooks on the inside face of the front blanket. These are secured to the exposed front edge of the cooking chamber. Two notches in the blanket fit around the two front shelf mounting cylinders.

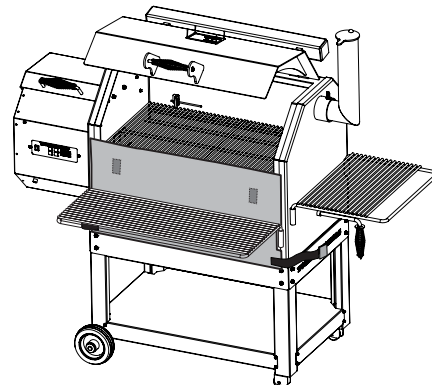

Front blanket installed; front shelf reinstalled.

2. Installation of Top Blanket:

Install the top blanket as shown in the following illustration:

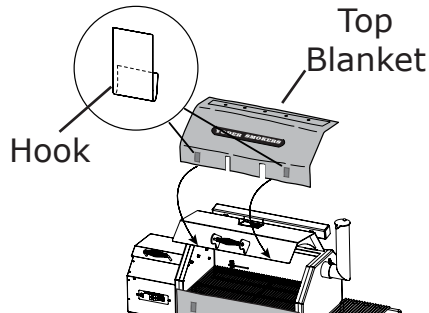

Two hooks on underside of blanket fasten to lower edge of raised lid. Two notches in the blanket slide over handle brackets; Yoder Smoker logo faces up; eyelets for attaching back blanket are facing up.

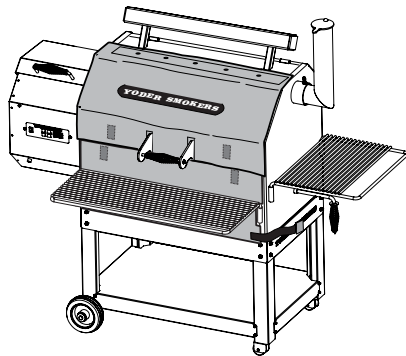

Top blanket installed; lid closed.

3. Installation of Back Blanket

Install the back blanket as shown in the following illustration:

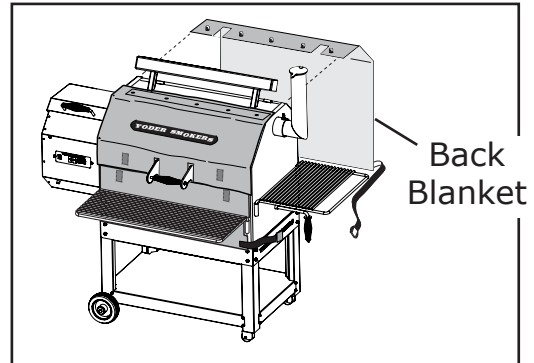

Blanket is slotted to fit around arms of counterweight. Front edge of blanket slides under top blanket and twist tabs fit into mating slots in top blanket. Rotate tabs 90° to lock in place.

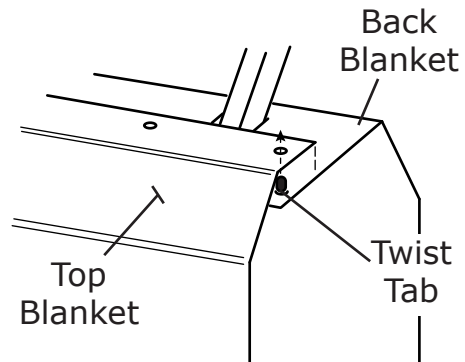

With top and back blankets secured to one another, final step is to fasten lower belts of back blanket to lower belts of front blanket. Adjust for a snug fit.

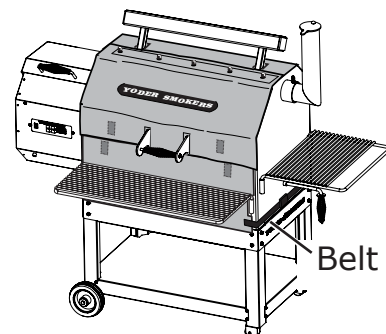

End of Procedure