

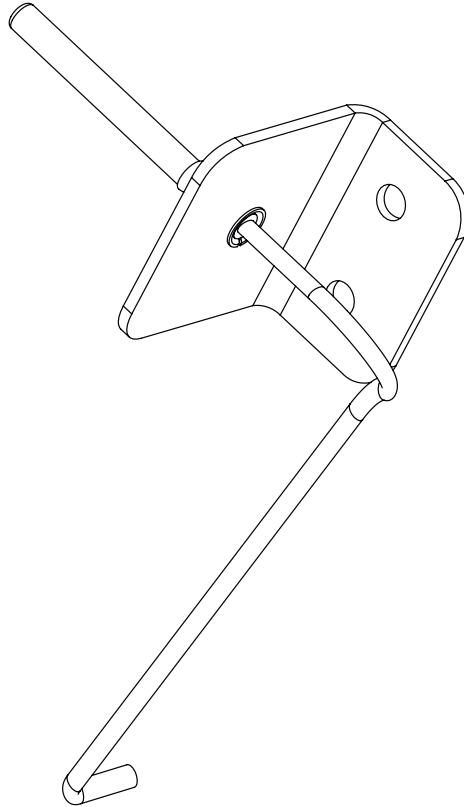

SHORT THERMOCOUPLE REPLACEMENT

YS640 / YS480 INSTALLATION INSTRUCTIONS



TOOLS YOU'LL NEED

5/16" Socket | Small Adjustable Wrench | Phillips Screwdriver | Small Flathead Screwdriver

THINGS TO REMEMBER



UNPLUG
POWER CORD



REMOVE
COOKING GRATES



REMOVE
HEAT DIFFUSER



EMPTY
THE HOPPER



CAUTION: BEFORE BEGINNING THIS PROCEDURE, ENSURE THAT THE POWER CORD TO THE SMOKER IS DISCONNECTED! FAILING TO DO SO MAY RESULT IN BODILY INJURY.
COMPETITION CART MODELS REQUIRE UNPLUGGING THE POWER CORD FROM THE HOPPER LOCATED UNDER THE CART.

STEP 1

Remove the end panel by removing the eleven self-drilling screws using the 5/16" socket to gain access into the hopper.

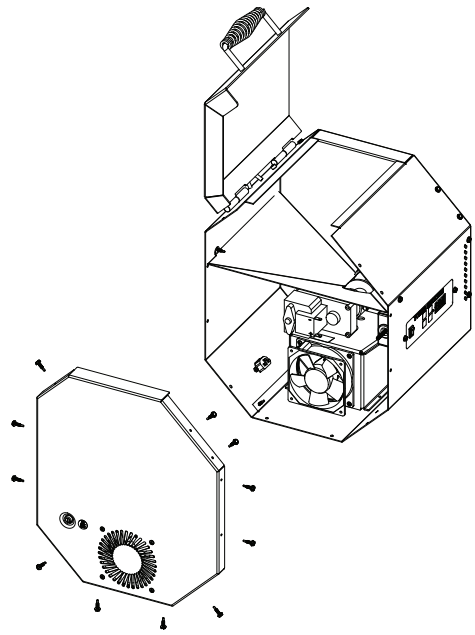

STEP 4

Disconnect the Wi-Fi extension wire from the controller using a small adjustable wrench.

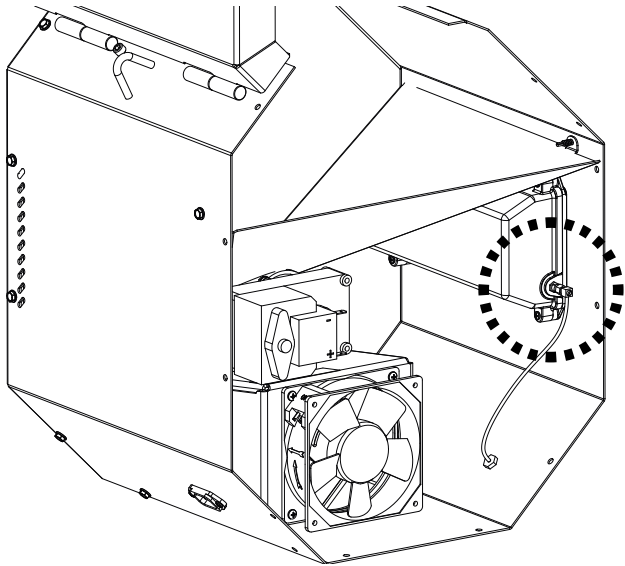

STEP 2

Disconnect the two wires (one green, one white) from the outer fan.
NOTE: On competition cart models disconnect the two purple wires from the fuse holder.

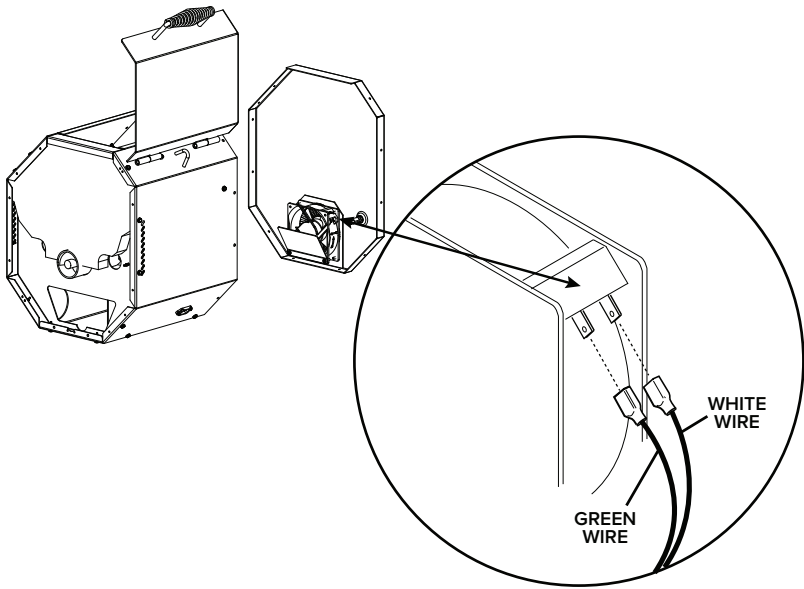

STEP 5

Remove the two screws from the controller using a Phillips head screwdriver..

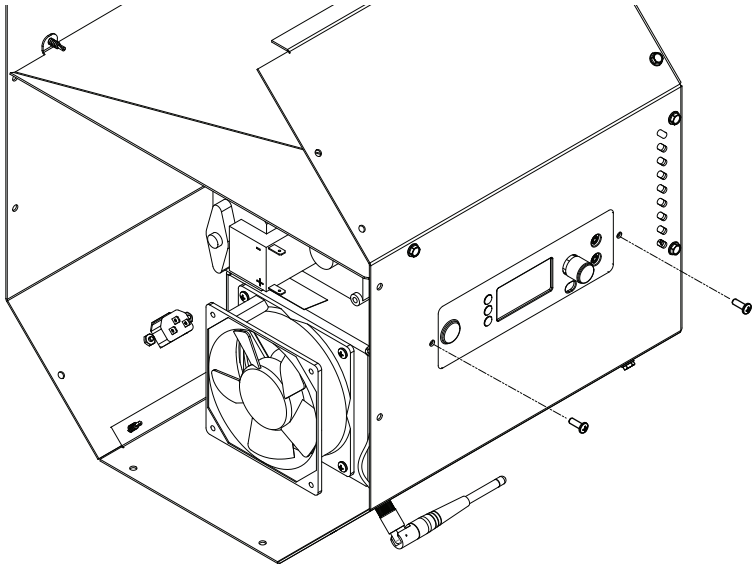

STEP 3

Disconnect the purple wires from the fuse holder.

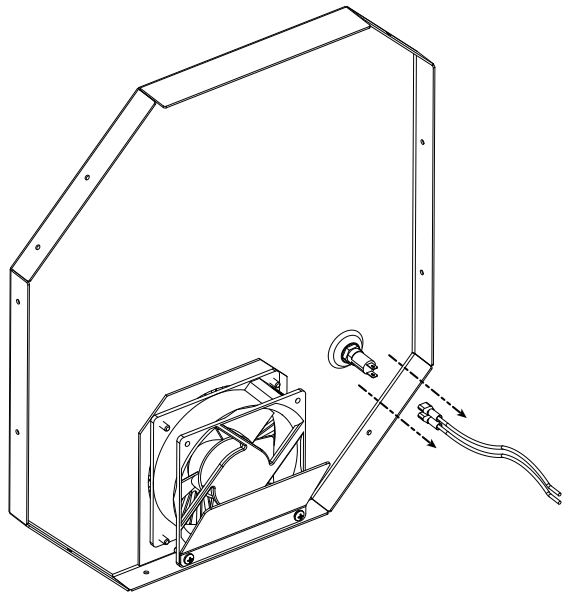

STEP 6

Remove the four screws located on the back side of the controller box..

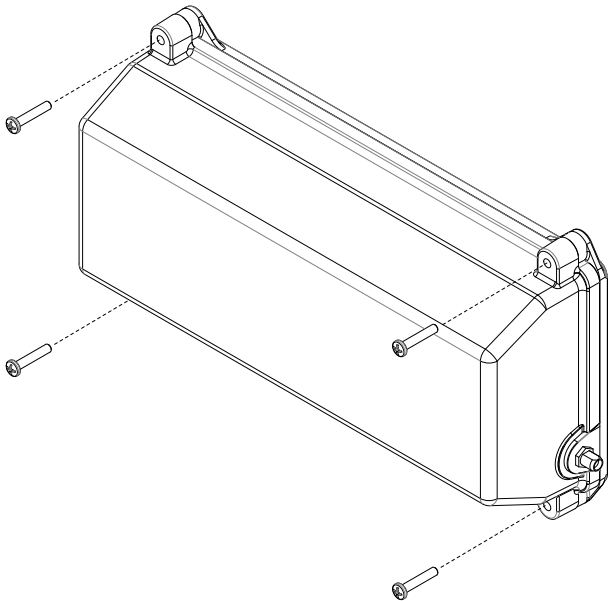

STEP 7

Carefully remove the box from the controller by sliding the harness through the slot in the box.

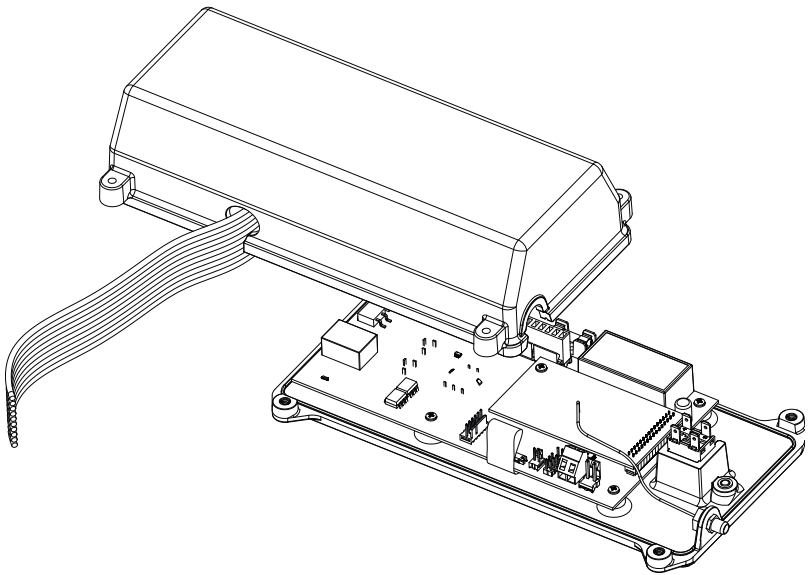

STEP 10

Remove thermocouple mounting bracket by unscrewing the two 10x34 screws. Save screws for installation of new thermocouple. Gently pull thermocouple wires out of hopper through hole.

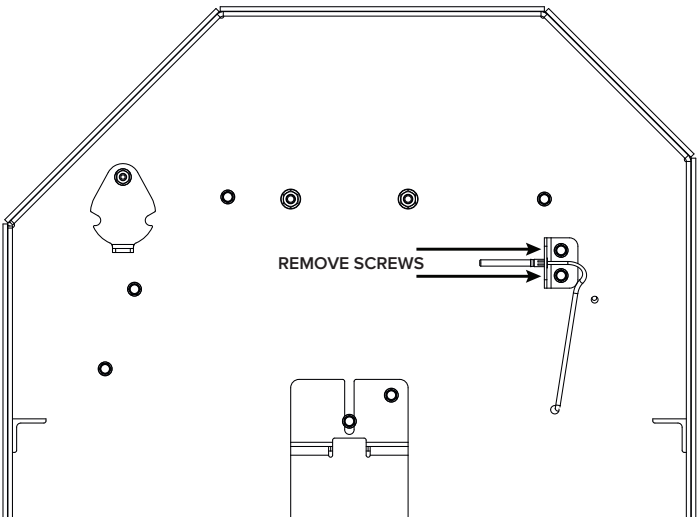

STEP 8

Using the small flat head screwdriver, disconnect the red and white thermocouple wires from the terminals on the ACS controller.

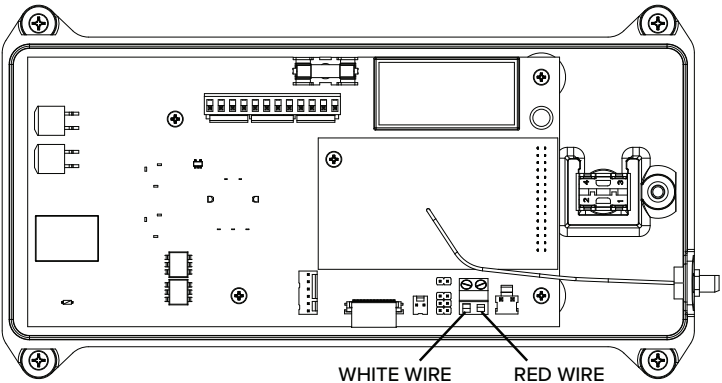

STEP 11

Secure new thermocouple mounting bracket using the two 10x34 screws. Then feed thermocouple wire back through hole into hopper..

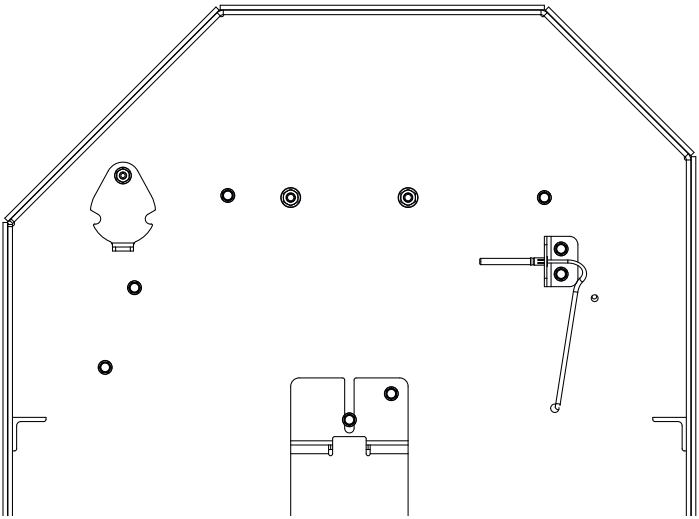

STEP 9

Remove the screw (as shown) to remove the thermocouple wire cover.

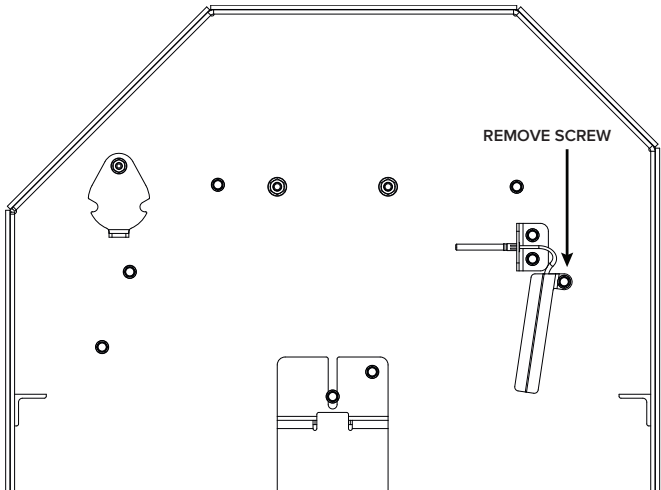

STEP 12

Secure the wire cover with the self-drilling screw..

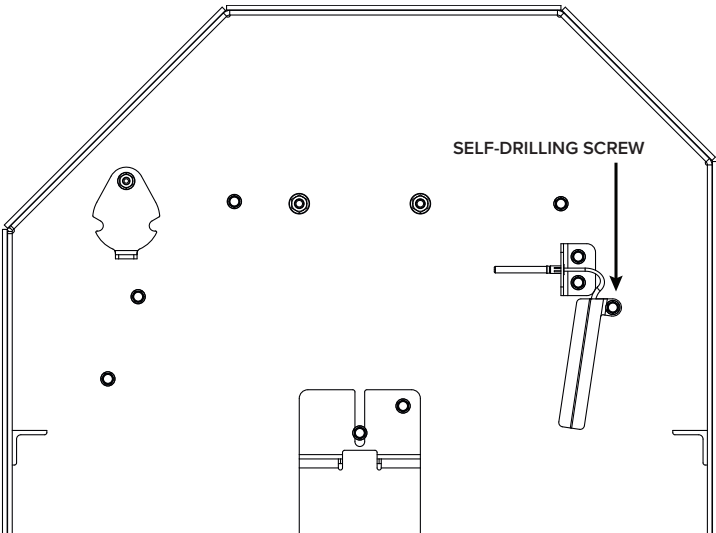

STEP 13

Using the small flat head screwdriver, install the red and white thermocouple wires into the correct terminals on the ACS controller. When installing the new thermocouple wires, please double check your connection to make sure there is little to no exposed wire where they are connected to the terminal..

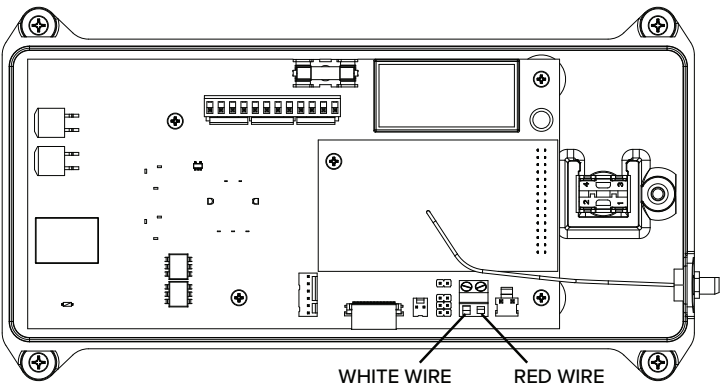

STEP 16

Attach the Wi-Fi extension wire to the controller using a small adjustable wrench.

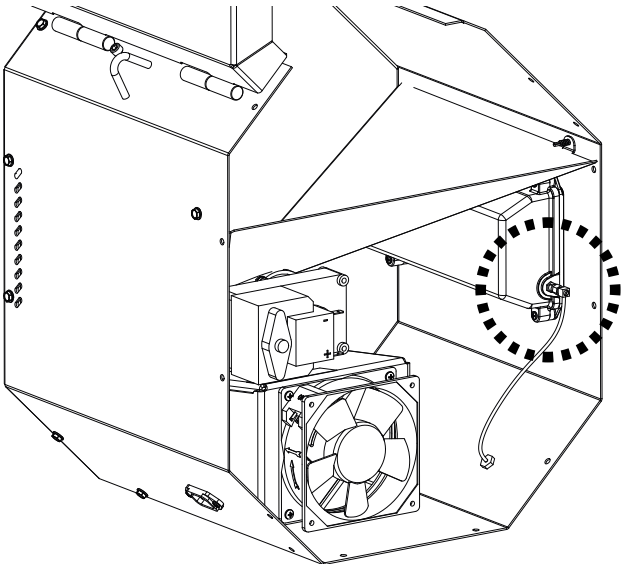

STEP 14

Slide the harness and thermocouple wire through the slot on the box and secure the box to the controller using the four screws removed earlier. **NOTE: Take care to not crimp or pinch the ribbon cable or any wires in the process of closing the box.**

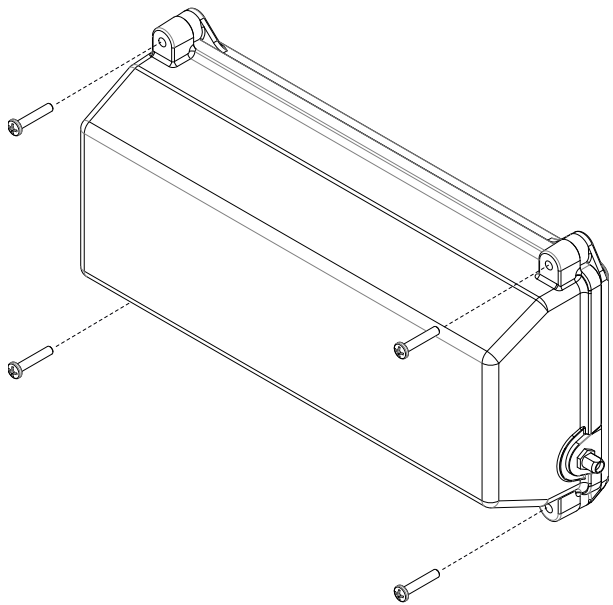

STEP 17

Connect the two purple wires to the fuse holder.

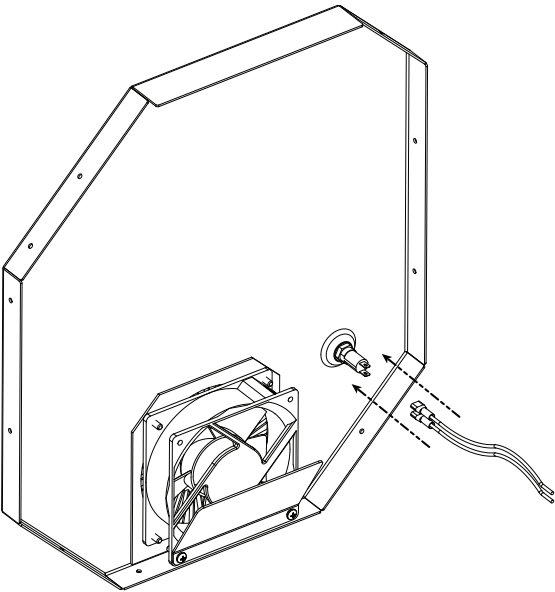

STEP 15

Install the ACS controller into the hopper and secure it in place using the two screws removed from the faceplate.

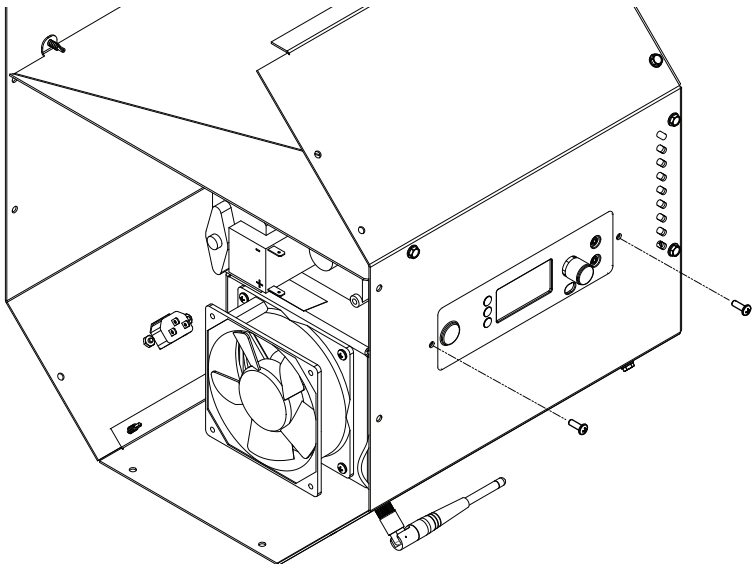

STEP 18

Connect the two wires (one green, one white) to the outer fan.

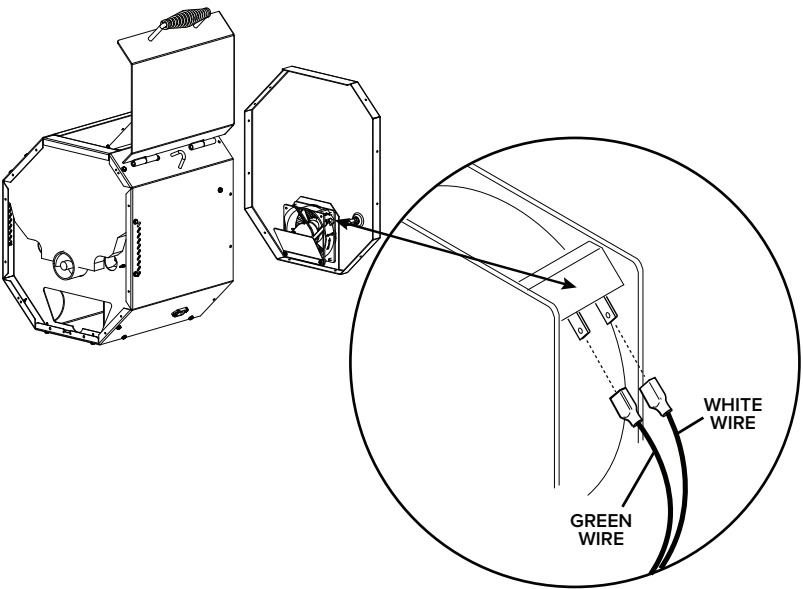

STEP 19

Ensure all wires are free of both fans and the auger drive motor. Lastly, attach the end panel to the hopper using the eleven self-drilling screws.

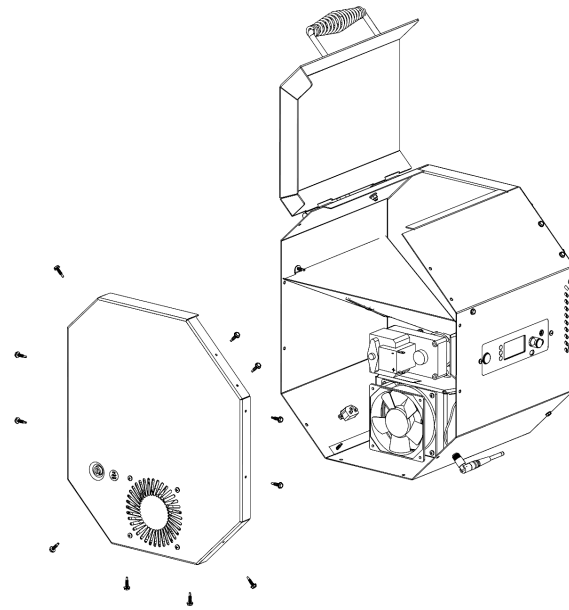

**THIS COMPLETES
THE HARDWARE INSTALL**



FOR PRODUCT SUPPORT:

877.409.6337 (Ext. 2)

customerservice@yodersmokers.com

WWW.YODERSMOKERS.COM