

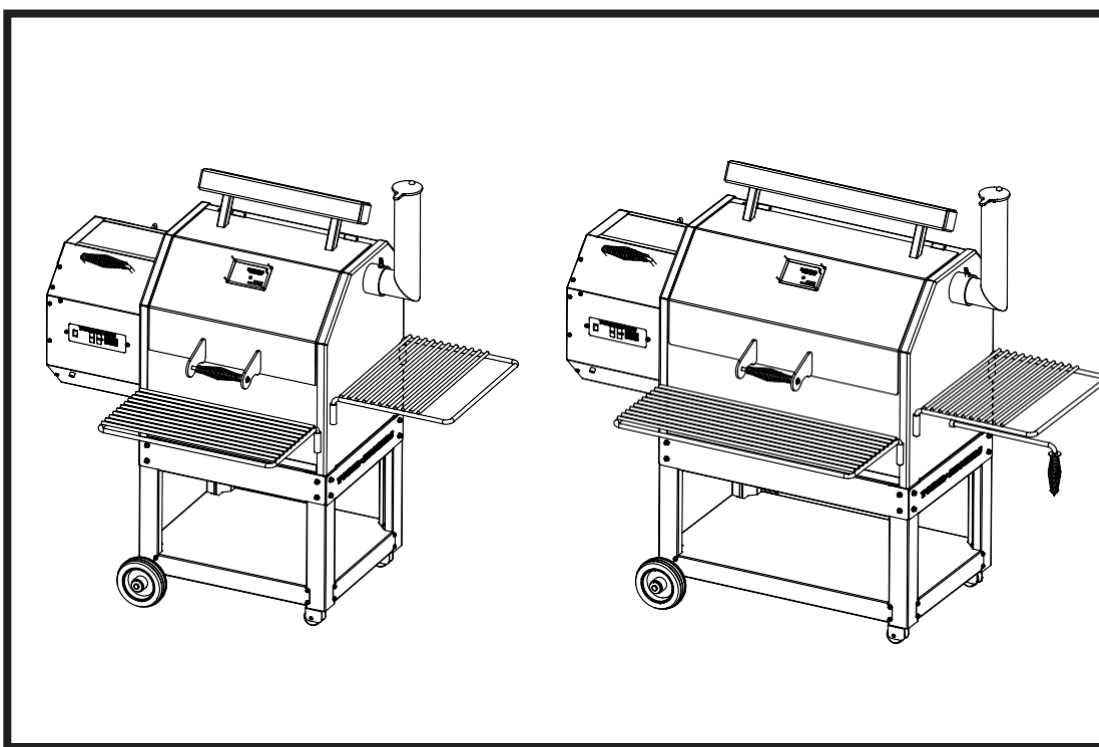

## PROCEDURE FOR UPGRADING FROM THE STEEL IGNITER TO A CERAMIC IGNITER



VERSION 1 - APR, 2019

# Procedure for Replacing the Igniter:

**! CAUTION:** BEFORE BEGINNING THIS PROCEDURE, INSURE THAT THE POWER CORD TO THE SMOKER IS DISCONNECTED! FAILURE TO DO SO MAY RESULT IN BODILY INJURY.

## TOOLS REQUIRED

1. 5/16" Socket
2. Small socket extension
3. Ratchet

## PARTS REQUIRED

A92311 - Ceramic Igniter Assembly

1. Remove cooking grates and diffuser. See FIG 1.

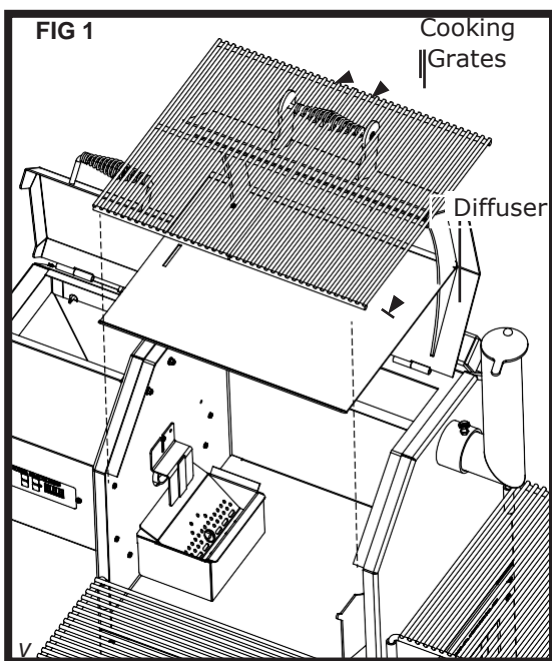

2. Remove the Burn Grate. See FIG 2.

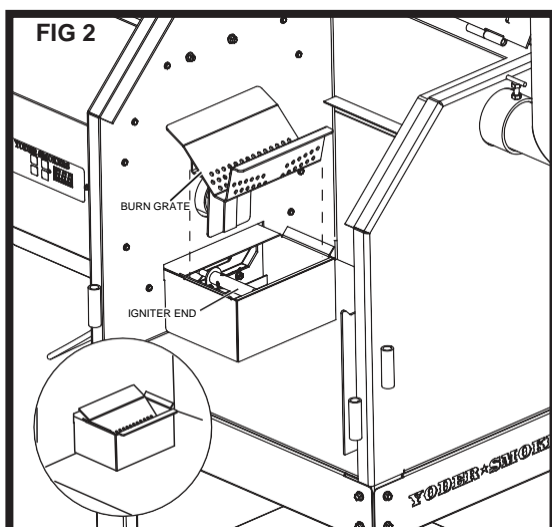

3. Using a 5/16" socket and extension to remove the igniter housing from the chamber wall.

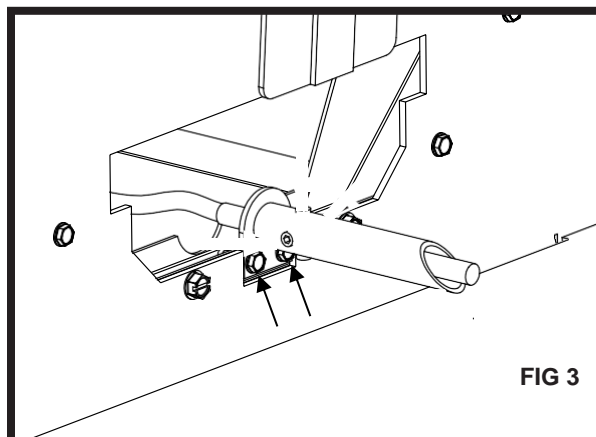

4. Pull the wires out of the opening to the hopper to expose the electrical connector. Pull apart the electrical connector for the igniter FIG 4

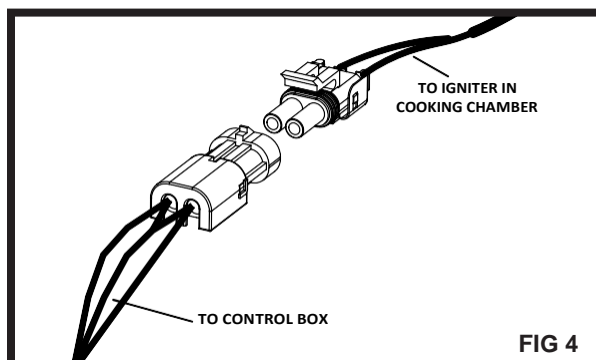

5. Use the 5/16" socket and extension to secure the new ceramic igniter housing to the chamber wall.

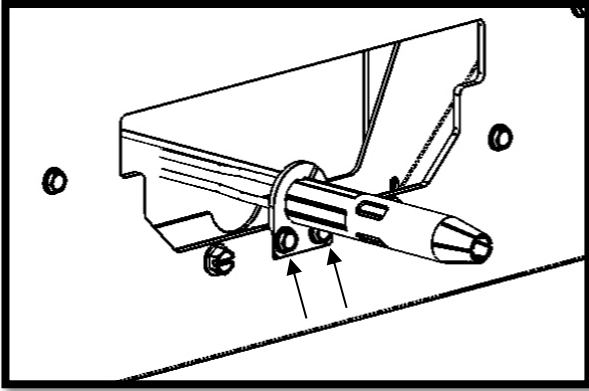

6. Attach igniter cable at electrical connector. See **FIG 4**. Tuck the wire back inside the hopper away from firepot.
7. The 1.6 amp fuse must be replaced with the supplied 5 amp with the ceramic igniter. **Note: IF THE FUSE IS NOT REPLACED, IT WILL BLOW DURING STARTUP.**

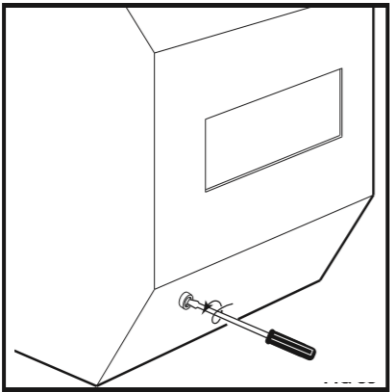

8. Install burn grate, heat diffuser plate (if used) and cooking grates. See **FIG 1 and 2**.
9. Start up the pit. Ignition should start within 4 minutes.

**END OF PRODEDURE**