

# ★ YODER SMOKERS ★

PREMIUM GRILLS & SMOKERS

## AUGER MOTOR REPLACEMENT

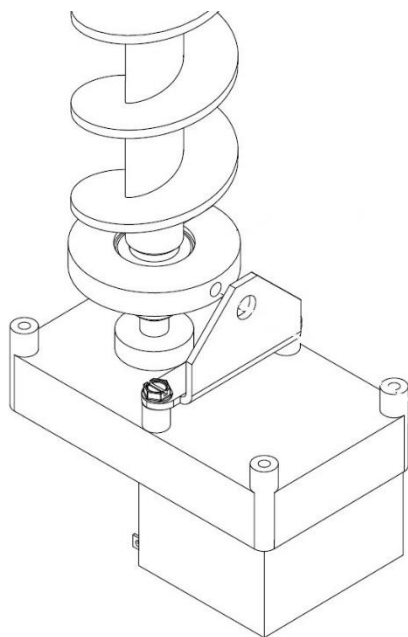

### TOOLS YOU'LL NEED

5/16" SOCKET | SMALL SOCKET EXTENSION | RATCHET |  
3/16" HEX KEY | 5/32" HEX KEY



**UNPLUG**  
POWER CORD



**EMPTY**  
THE HOPPER



**CAUTION:** BEFORE BEGINNING THIS PROCEDURE, ENSURE THAT THE POWER CORD TO THE SMOKER IS DISCONNECTED! FAILING TO DO SO MAY RESULT IN BODILY INJURY.

**COMPETITION CART MODELS REQUIRE UNPLUGGING THE POWER CORD FROM THE HOPPER LOCATED UNDER THE CART.**

1. Remove the end panel by removing the eleven self-drilling screws using the 5/16" socket to gain access into the hopper.

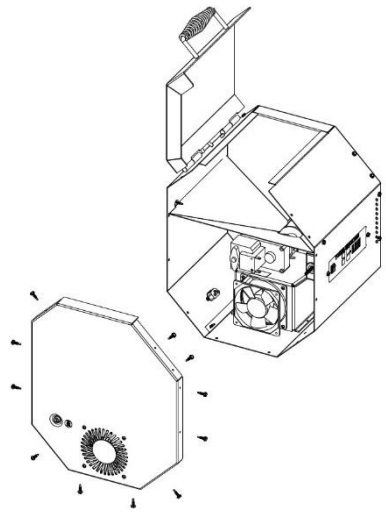

2. Disconnect the two wires (one green, one white) from the outer fan. (**Comp cart/ACS models:** Disconnect the purple wires from the the end panel.)

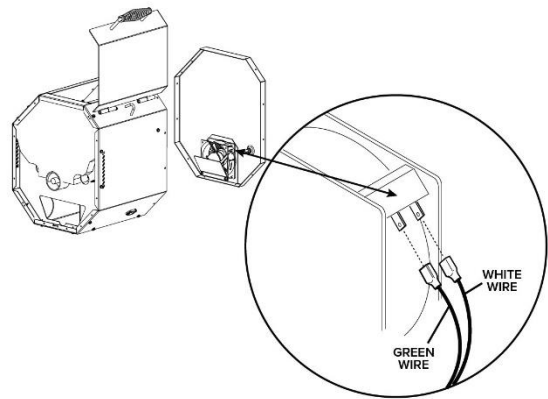

3. Disconnect the black and red wire from the auger motor.

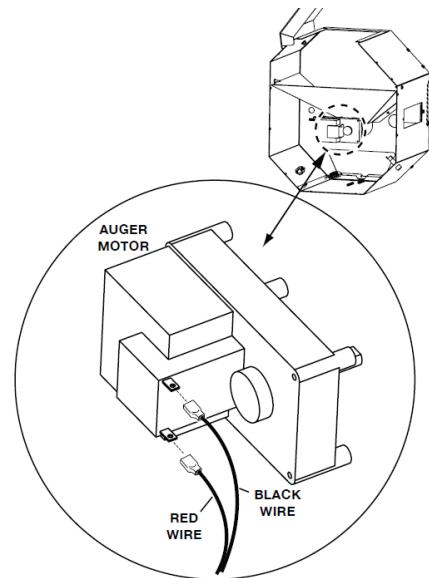

4. Remove the 2 bolts securing the auger motor using the 3/16" hex key and 5/32" hex key. Then remove the auger motor from the hopper.

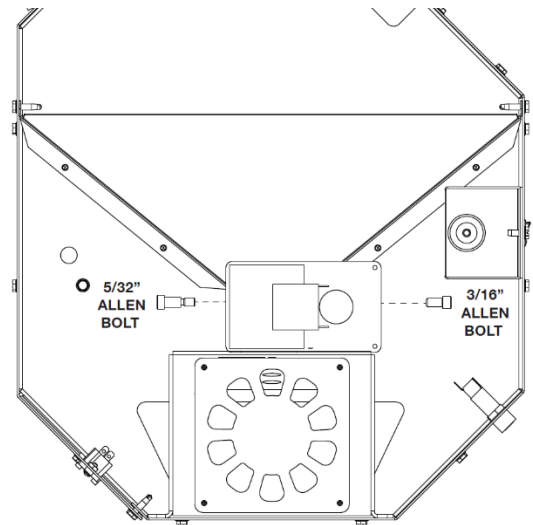

5. On the new auger motor assembly, remove the 5/32" bolt.

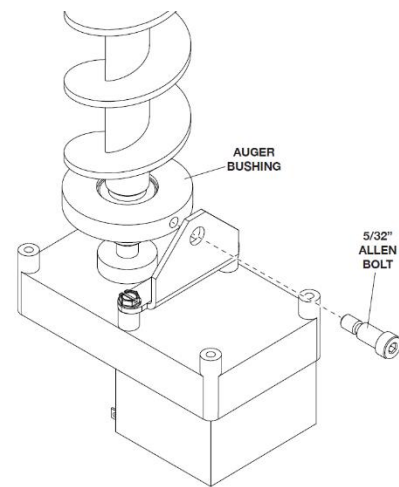

6. Insert the auger motor assembly into the tube and screw the two bolts into the motor. Start the bolts by hand first, then tighten the 3/16" bolt first.

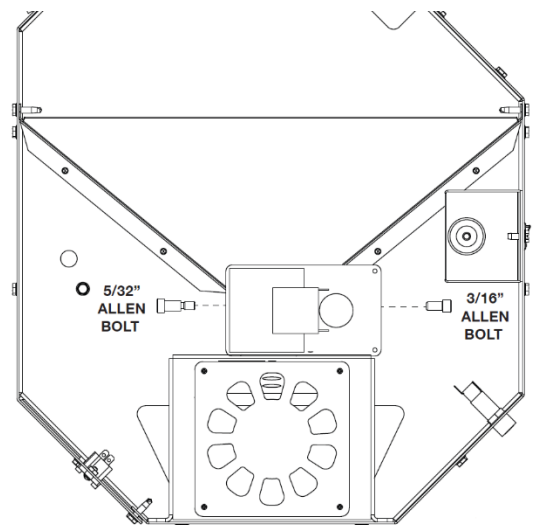

7. Connect the black and red wire to the auger motor.

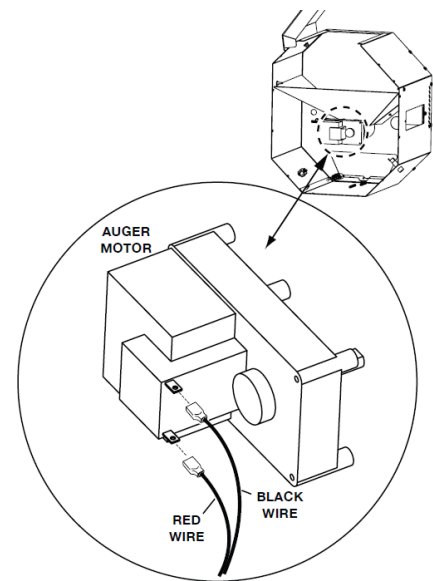

8. Attach the green and white wire to the outer fan. (**Comp cart/ACS models:** Attach the purple wires from the the end panel.)

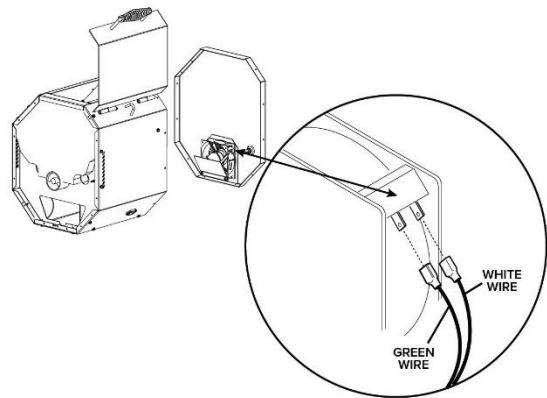

9. Ensure all wires are free of both fans. Lastly, attach the end panel to the hopper using the eleven self-drilling screws.

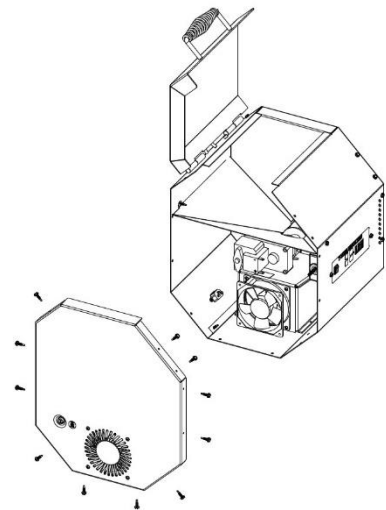

**THIS COMPLETES THE  
HARDWARE INSTALL**



**FOR PRODUCT SUPPORT:**

877.409.6337 (Ext. 2)

[customerservice@yodersmokers.com](mailto:customerservice@yodersmokers.com)

**[WWW.YODERSMOKERS.COM](http://WWW.YODERSMOKERS.COM)**