

YODER ★ SMOKERS

A91850

Installing a factory probe port into a Yoder Smoker pellet grill

YS640, YS480 and YS1500 models

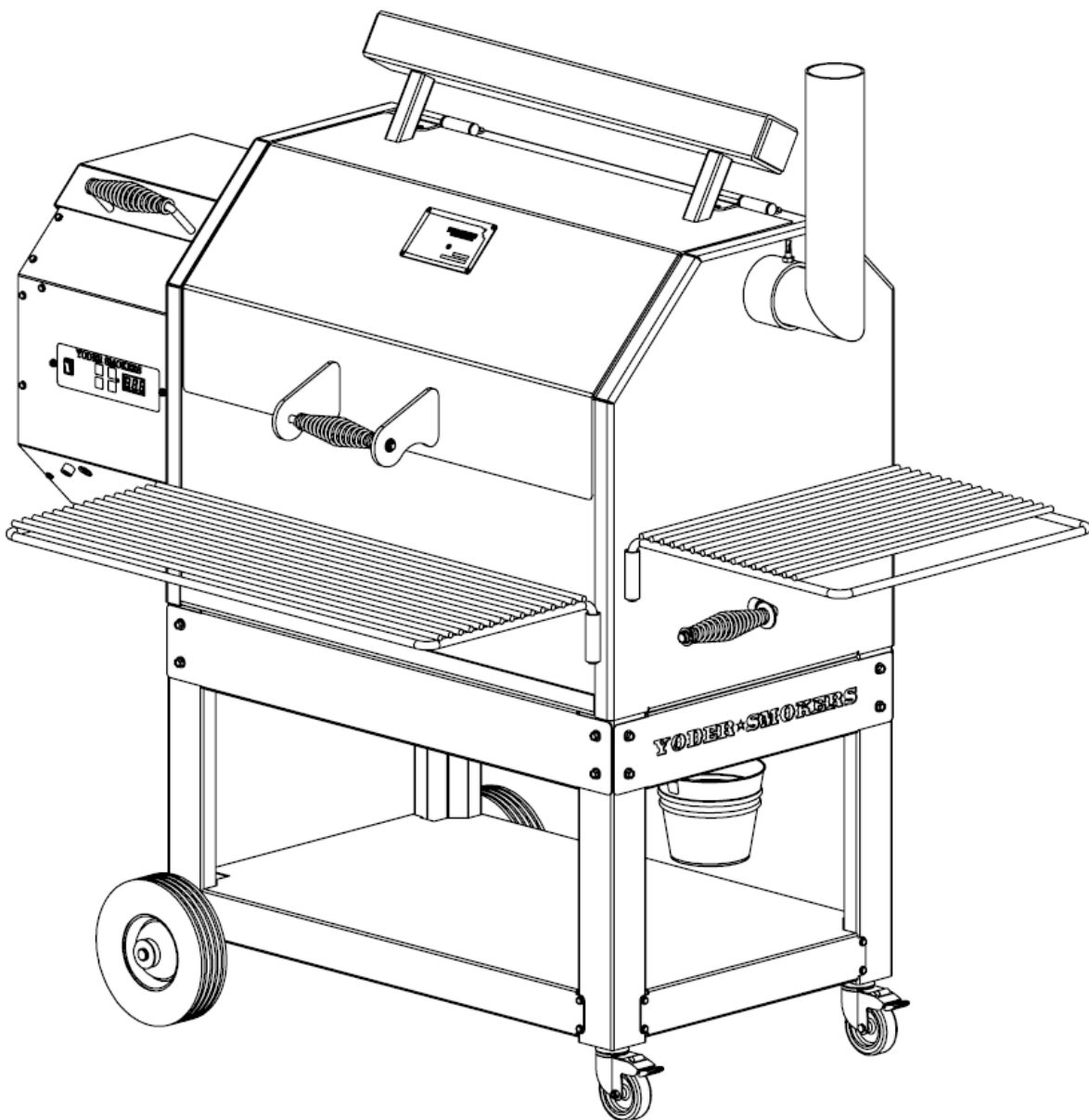

Install factory probe port as follows:

TOOLS REQUIRED:

1. Tape Measure
2. Pencil
3. 1/4" Drill Bit
4. 3/4" Drill Bit
5. 1 1/8" Drill Bit
6. 7/32" Drill Bit
7. Drill
8. 1/8" Allen Wrench
9. 3/8" Wrench or Socket

PARTS REQUIRED:

1. 91741 Probe Port Cover Stainless
2. 91742 Flat Washer #10
3. 91762 Spacer
4. 91777 Hi-Temp Silicone Plug
5. 1024FLN 10-24 Top Lock Flange Nut
6. 1024X34BHCSST Button Head Screw Stainless

PREPARATION OF THE SMOKER UNIT:

1. Measure and mark the location of the two holes on the hopper side of the chamber. Place some painter's tape where the holes are to be drilled to protect the surface from scratches. Then re-measure the location for the holes and remove the tape when finished drilling.

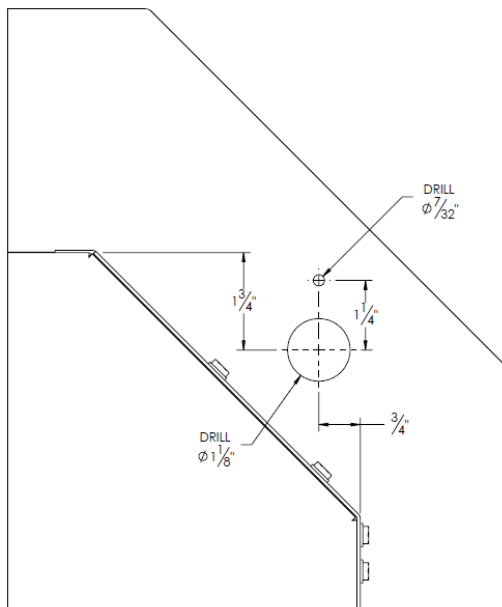

2. You may choose to use the template provided at the end of these instructions to mark the location of the two holes on the hopper side of the chamber.
3. **To use the template:** Punch a hole in the centerline of each hole on the template and then cut along the dotted line. Align the cutout of the template along the edge of the hopper and against the chamber as shown in the illustration below. Mark the two holes in the center, remove the template and follow steps 4 through 9.

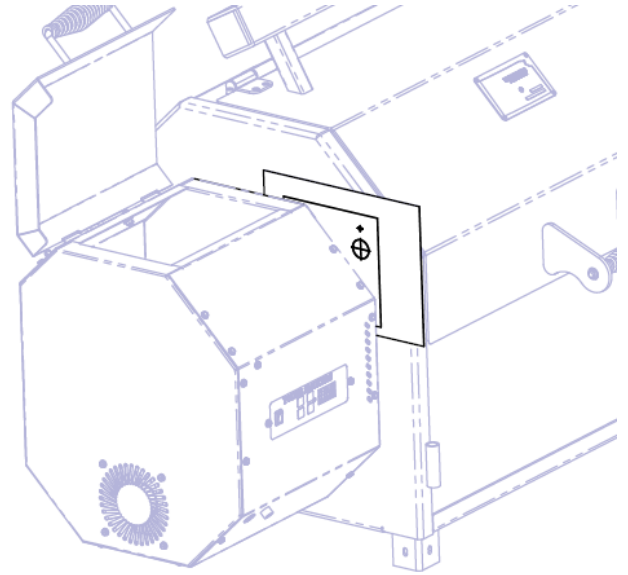

4. Drill the 7/32" hole
5. For the 1 1/8" hole, we recommend drilling a 1/4" pilot hole then drill the hole with the 3/4" bit and finish with the 1 1/8" bit.
6. Deburr the hole from inside the chamber. **(Failure to do this will cause the probe port cover to not close properly)**
7. Touch up any exposed metal using high heat black paint.

8. Install the probe port using the diagram below.

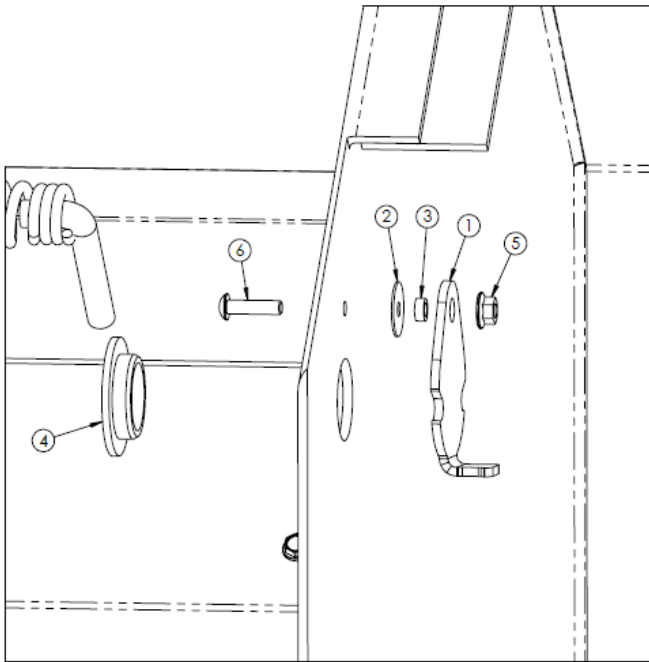

9. Use the 1/8" Allen wrench and 3/8" wrench or socket to secure the probe port cover in place and use the silicone plug to cover the hole.

