

YODER ★ SMOKERS

A90479

PROCEDURE FOR INSTALLATION OF THERMOMETER WITH STAINLESS STEEL BASE MOUNT

VEFRS I - 1/9/012

Install Thermometer(s) in Pellet model YS480 or YS640 as follows:

TOOLS REQUIRED:

1. Tape Measure
2. .53" (17/32") dia. Drill Bit; Power Drill
3. 3/4" Wrench
4. 3/8" Allen Wrench
5. Small, flat blade (jewelers) screwdriver

PARTS REQUIRED:

1. Part No. A90479 Thermometer Assembly, Complete.
or
1. P/N 23584 - Thermometer
2. P/N 90480, Thermometer Base Screw
3. P/N 1213JHNSS, Hex Nut, 1/2-13 stainless steel.
4. P/N 832x516SHSSSS - Set Screw, cone point, 8-32 x 5/16, stainless steel slot head.

PREPARATION OF THE SMOKER UNIT:

1. Measure and mark location of hole(s) in pellet smoker lid as shown in fig 1 (NOTE: If a single thermometer is to be installed, mark hole location at "A". If two thermometers are to be installed, mark hole locations at "A" and "B".

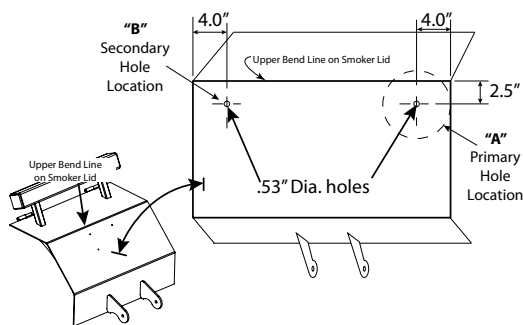

fig 1

2. Drill marked hole(s) using 17/32" bit in a power drill.

INSTALL THERMOMETER(S):

3. Insert thermometer base mount (P/N 90480) in drilled hole(s). Secure the base with 1/2-13 stainless steel hex nut (P/N 1213JHNSS). See fig 2.

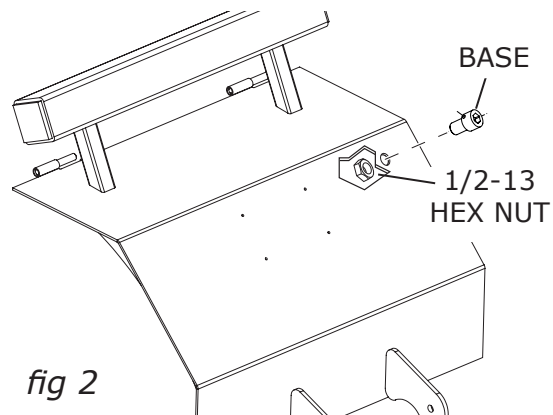

fig 2

4. Insert thermometer (P/N 23584) into base mount then rotate so that the temperature scale reads "right-side-up". Secure thermometer shank with set screw (P/N 832x516SHSSSS). See fig 3.

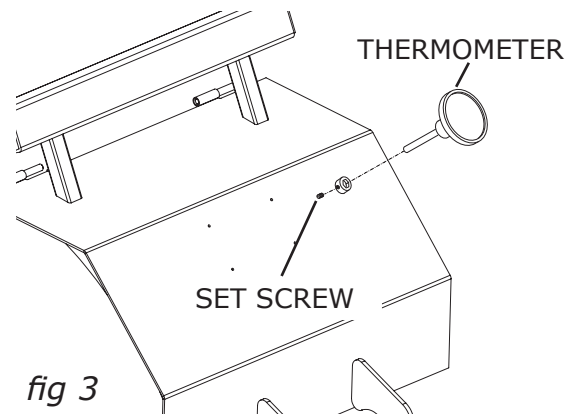

fig 3

END OF PROCEDURE