

★ **YODER SMOKERS** ★  
COMPETITION GRADE BBQ PRODUCTS

Pellet Smoker  
23988

PROCEDURE FOR INSTALLATION OF PROBE PORT FOR  
YS1500 AND OFFSET SMOKERS

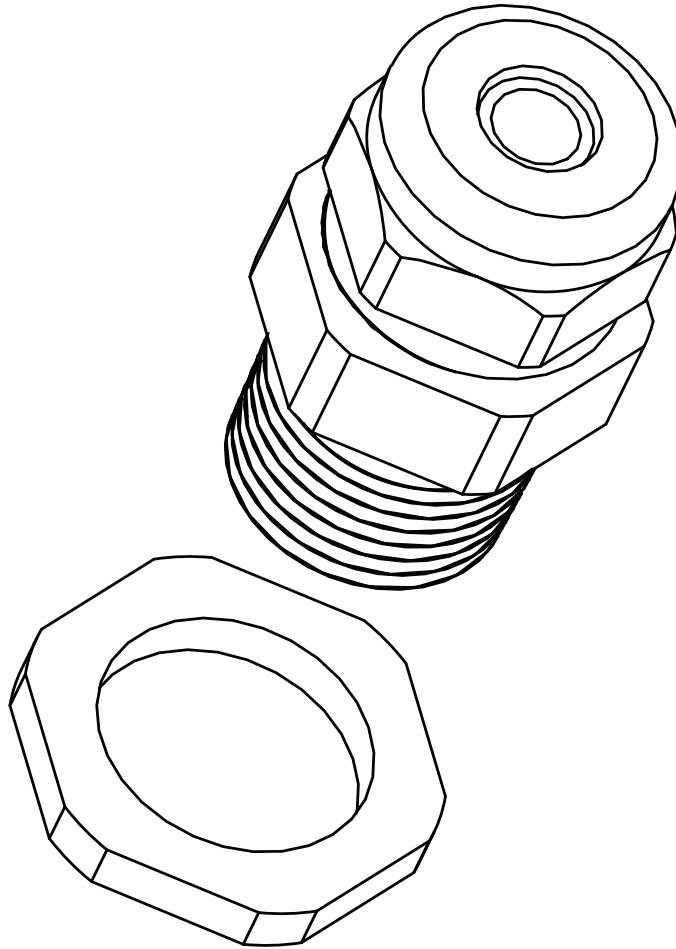

**Install Probe Port in Pellet model  
YS1500, Wichita or Cheyenne as follows:**

**TOOLS REQUIRED:**

1. Tape Measure
2. Pencil
3. 1/4" Drill Bit
4. 11/16" Drill Bit
5. Drill
6. 24mm Wrench or Crescent Wrench

**PARTS REQUIRED:**

1. Part No. 23988 Probe Port

**PREPARATION OF THE SMOKER UNIT:**

1. Measure and mark location of hole on the side of the body with the smoke stack.

Place some easily removable tape, i.e. 2" painters tape, where the hole is to be drilled to protect the surface from scratches. Then re-measure the location for the hole and remove the tape when finished drilling.

**Note:** Select your model below. If installing one port, use the location closest to the smoke stack. If Two, use both.

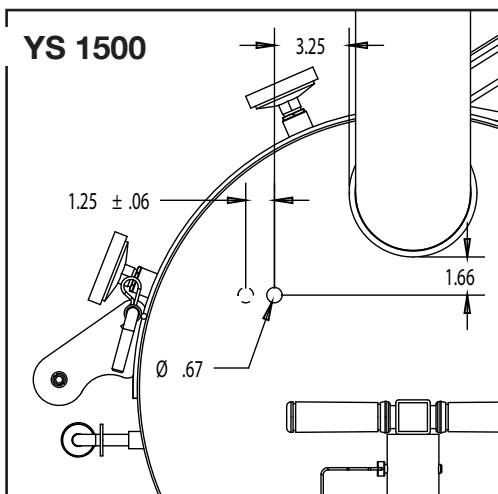
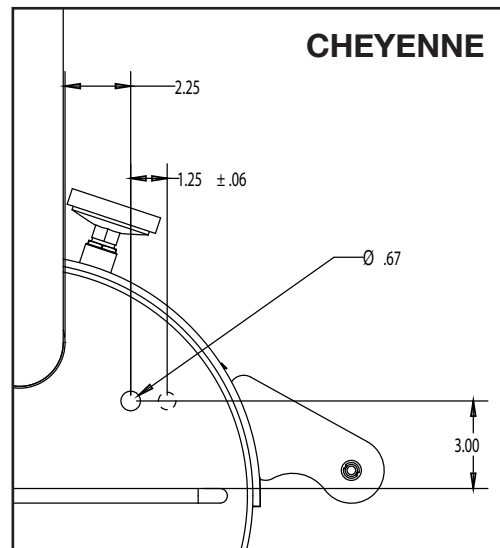
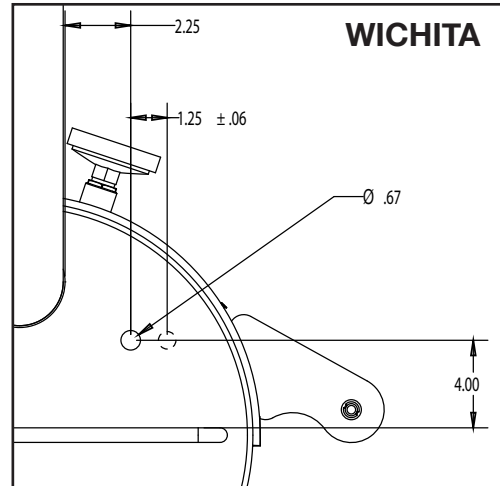

2. We recommend drilling a 1/4" pilot hole, then drill the hole with a 11/16" bit.
3. Insert probe port into the hole. Secure the probe port with stainless steel hex nut using a 24mm wrench or crescent wrench. See Below.

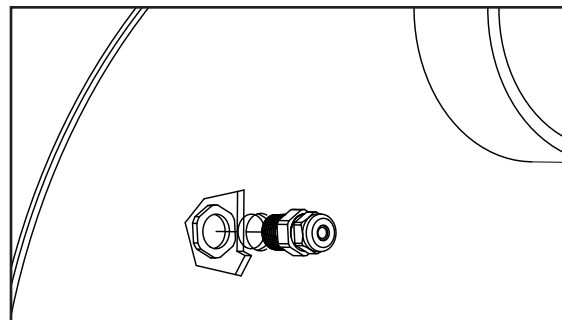

**END OF PROCEDURE**